



Golf School District 67

Drinking Fountains & Sink Faucets Water Sampling Summary and Results

HYNES ELEMENTARY SCHOOL

Rich Searl
Director of Buildings and Grounds
GOLF SCHOOL DISTRICT 67
9401 Waukegan Road
Morton Grove, IL 60053-1353

Via email: rsearl@golf67.net
voice: 847.966.5088

ENVIRONMENTAL SERVICES, INC. (ESI) performed “First Draw” potable water sampling and “Second Draw” sampling after running each regulated water source for 30 seconds. This sampling included hand washing sink faucets used by students younger than 1st Grade. Each sample was obtained by an Environmental Health Engineer and analyzed for Lead contamination by an EPA certified laboratory. The State of Illinois protocols and standards were applied.

All drinking water sources sampled meet the State of Illinois standard of 5 ug/L (micrograms per Liter [parts per billion]) or less and the EPA action level standard of 15 ug/L. Hand washing sink faucets in the Kindergarten and ECE classrooms were sampled as required by the Illinois regulations and with one exception (first draw in cold water Room 3) comply with the standard. The first draw from the Kitchen “Pot” faucet exceeded the Illinois and EPA standard.

Recommendations

- R1. The common area drinking fountains and pre-first grade sinks can remain in normal service. The sink in Room 3 and the Pot sink in the Kitchen should be flushed each morning until the source of Lead contamination can be identified and removed. Replacing the faucets may be all that is required.
- R2. Follow-up sampling is not required unless conditions change for those sources meeting the Illinois standard. Resampling in Room 3 and the Kitchen is recommended.
- R3. As required, the analytical results attached shall be posted on the District’s website,

If there are any questions, if additional information is requested, if additional follow-up sampling is requested, or if you would like to meet to discuss the results, please contact me.

ENVIRONMENTAL SERVICES, INC.

Nick Malone

Nick Malone, P.E.
M.S. Environmental Health Engineering

Analytical Report and Sampling Floor Plan Attached

NJM/ww2017

ESICHICAGO.COM
P.O. Box 688, La Grange, IL 60525-0688
708 354 7121 Fax 708 354 7142

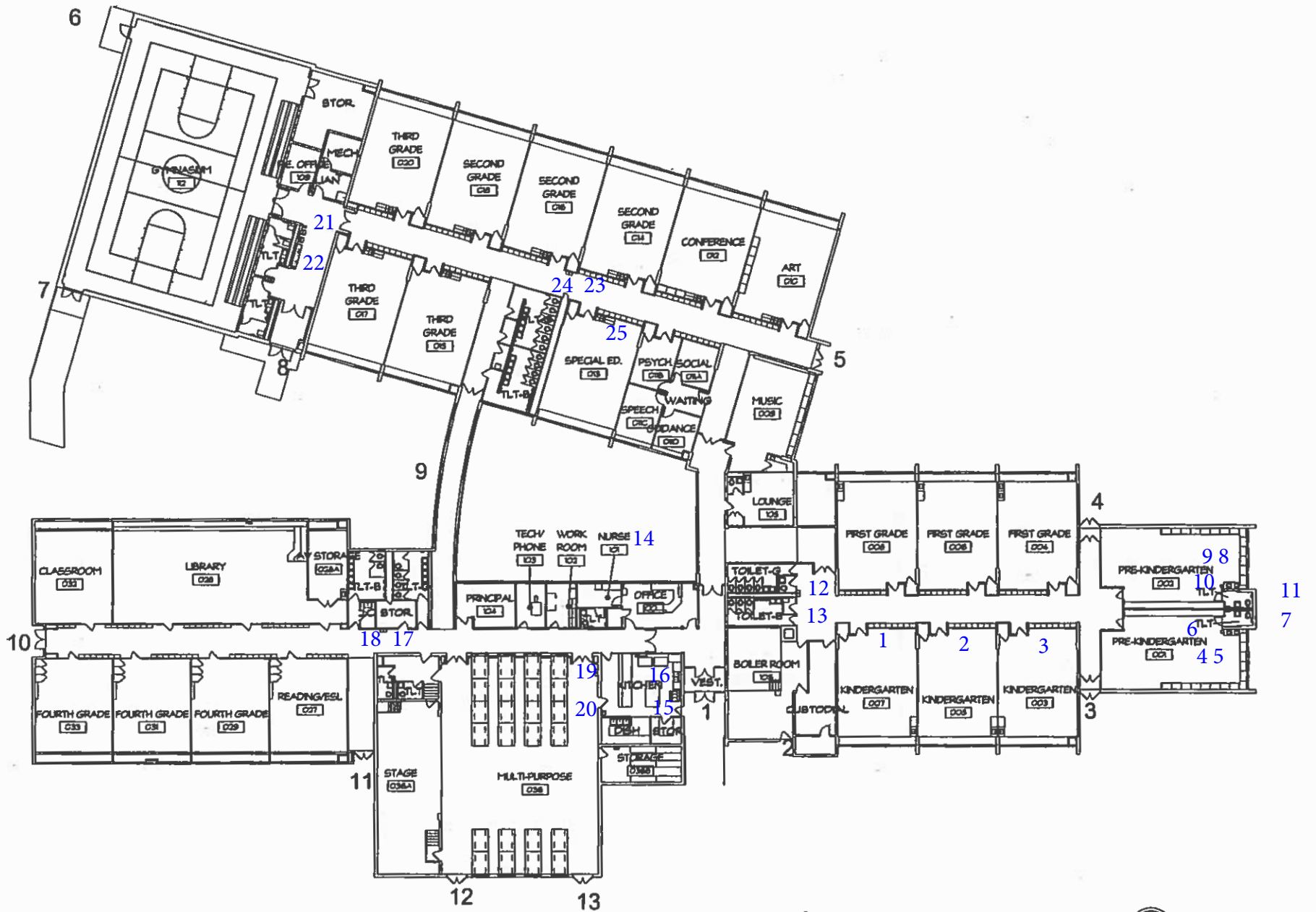

HYNES ELEMENTARY SCHOOL

WATER SAMPLING PLAN - ILLINOIS LEAD RULE POTABLE WATER SAMPLING MARCH 2017



SUBURBAN LABORATORIES, Inc.



1950 S. Batavia Ave., Suite 150 Geneva, Illinois 60134
Tel. (708) 544-3260 • Toll Free (800) 783-LABS
Fax (708) 544-8587
www.suburbanlabs.com

March 21, 2017

Nick Malone
Environmental Services Inc
1415 W. 55th - suite 201
Countryside, IL 60534

Workorder: 1703302

TEL: (708) 354-7121

FAX:

RE: 5242 G67 Drinking Water Lead Analysis

Dear Nick Malone:

Suburban Laboratories, Inc. received 61 sample(s) on 3/6/2017 for the analyses presented in the following report.

Customer has provided 250 mL volume sample bottles for all samples collected. Please note, all sample results that exceed 5.00 ug/L should be promptly reported to parents or guardians of all enrolled students. Results that are below 5.00 ug/L should be reported on the school website. Please refer to Public Act 099-0922 or the Illinois Department of Public Health for specific reporting requirements. Suburban Laboratories will forward all results to the IDPH within seven (7) business days from the date of this report.

This report may not be reproduced, except in full, without the prior written approval of Suburban Laboratories, Inc. If you have any questions regarding these test results, please call me at (708) 544-3260.

Sincerely,



Pat Rodriguez
Project Manager
708-544-3260 ext 214
pat@suburbanlabs.com



SUBURBAN LABORATORIES, Inc.



1950 S. Batavia Ave., Suite 150 Geneva, Illinois 60134
Tel. (708) 544-3260 • Toll Free (800) 783-LABS
Fax (708) 544-8587
www.suburbanlabs.com

Client ID: Environmental Services Inc

Report Date: March 21, 2017

Project Name: 5242 G67 Drinking Water Lead Analysis

Workorder: 1703302

Analyte: Lead

Matrix: Drinking Water

Sample ID	Client Sample ID	Result	MRL	Units	Date & Time Water System Last Used	Date Collected	Date Analyzed
1703302-001A	5242-1.1	2.61	2.00	µg/L		3/3/2017	3/15/2017
1703302-002A	5242-1.2	ND	2.00	µg/L		3/3/2017	3/15/2017
1703302-003A	5242-1.3	ND	2.00	µg/L		3/3/2017	3/15/2017
1703302-004A	5242-2.1	ND	2.00	µg/L		3/3/2017	3/15/2017
1703302-005A	5242-2.2	ND	2.00	µg/L		3/3/2017	3/15/2017
1703302-006A	5242-2.3	ND	2.00	µg/L		3/3/2017	3/15/2017
1703302-007A	5242-3.1	15.2	2.00	µg/L		3/3/2017	3/15/2017
1703302-008A	5242-3.2	ND	2.00	µg/L		3/3/2017	3/15/2017
1703302-009A	5242-3.3	4.49	2.00	µg/L		3/3/2017	3/15/2017
1703302-010A	5242-4.1	ND	2.00	µg/L		3/3/2017	3/15/2017
1703302-011A	5242-4.2	ND	2.00	µg/L		3/3/2017	3/15/2017
1703302-012A	5242-4.3	ND	2.00	µg/L		3/3/2017	3/15/2017
1703302-013A	5242-5.1	ND	2.00	µg/L		3/3/2017	3/15/2017
1703302-014A	5242-5.2	ND	2.00	µg/L		3/3/2017	3/15/2017
1703302-015A	5242-5.3	ND	2.00	µg/L		3/3/2017	3/15/2017
1703302-016A	5242-6.1	ND	2.00	µg/L		3/3/2017	3/15/2017
1703302-017A	5242-6.2	ND	2.00	µg/L		3/3/2017	3/15/2017
1703302-018A	5242-7.1	ND	2.00	µg/L		3/3/2017	3/15/2017
1703302-019A	5242-7.2	ND	2.00	µg/L		3/3/2017	3/15/2017
1703302-020A	5242-8.1	ND	2.00	µg/L		3/3/2017	3/15/2017
1703302-021A	5242-8.2	ND	2.00	µg/L		3/3/2017	3/15/2017
1703302-022A	5242-8.3	ND	2.00	µg/L		3/3/2017	3/15/2017
1703302-023A	5242-9.1	ND	2.00	µg/L		3/3/2017	3/15/2017
1703302-024A	5242-9.2	ND	2.00	µg/L		3/3/2017	3/15/2017
1703302-025A	5242-9.3	ND	2.00	µg/L		3/3/2017	3/15/2017
1703302-026A	5242-10.1	ND	2.00	µg/L		3/3/2017	3/15/2017
1703302-027A	5242-10.2	ND	2.00	µg/L		3/3/2017	3/15/2017
1703302-028A	5242-11.1	ND	2.00	µg/L		3/3/2017	3/15/2017
1703302-029A	5242-11.2	ND	2.00	µg/L		3/3/2017	3/15/2017
1703302-030A	5242-12.1	ND	2.00	µg/L		3/3/2017	3/15/2017
1703302-031A	5242-12.2	ND	2.00	µg/L		3/3/2017	3/15/2017
1703302-032A	5242-13.1	ND	2.00	µg/L		3/3/2017	3/15/2017
1703302-033A	5242-13.2	ND	2.00	µg/L		3/3/2017	3/15/2017
1703302-034A	5242-14.1	ND	2.00	µg/L		3/3/2017	3/15/2017
1703302-035A	5242-14.2	ND	2.00	µg/L		3/3/2017	3/15/2017
1703302-036A	5242-15.1	35.3	2.00	µg/L		3/3/2017	3/15/2017
1703302-037A	5242-15.2	ND	2.00	µg/L		3/3/2017	3/15/2017
1703302-038A	5242-16.1	ND	2.00	µg/L		3/3/2017	3/15/2017

ND - Not Detected Down to the Laboratory Minimum Reporting Limit (MRL)

SUBURBAN LABORATORIES, Inc.



1950 S. Batavia Ave., Suite 150 Geneva, Illinois 60134

Tel. (708) 544-3260 • Toll Free (800) 783-LABS

Fax (708) 544-8587

www.suburbanlabs.com

Client ID: Environmental Services Inc

Report Date: March 21, 2017

Project Name: 5242 G67 Drinking Water Lead Analysis

Workorder: 1703302

Analyte: Lead

Matrix: Drinking Water

Sample ID	Client Sample ID	Result	MRL	Units	Date & Time Water System Last Used	Date Collected	Date Analyzed
1703302-039A	5242-16.2	ND	2.00	µg/L		3/3/2017	3/15/2017
1703302-040A	5242-16.3	ND	2.00	µg/L		3/3/2017	3/15/2017
1703302-041A	5242-17.1	ND	2.00	µg/L		3/3/2017	3/15/2017
1703302-042A	5242-17.2	ND	2.00	µg/L		3/3/2017	3/15/2017
1703302-043A	5242-18.1	ND	2.00	µg/L		3/3/2017	3/15/2017
1703302-044A	5242-18.2	ND	2.00	µg/L		3/3/2017	3/15/2017
1703302-045A	5242-19.1	ND	2.00	µg/L		3/3/2017	3/15/2017
1703302-046A	5242-19.2	ND	2.00	µg/L		3/3/2017	3/15/2017
1703302-047A	5242-19.3	ND	2.00	µg/L		3/3/2017	3/15/2017
1703302-048A	5242-20.1	ND	2.00	µg/L		3/3/2017	3/15/2017
1703302-049A	5242-20.2	ND	2.00	µg/L		3/3/2017	3/15/2017
1703302-050A	5242-21.1	ND	2.00	µg/L		3/3/2017	3/15/2017
1703302-051A	5242-21.2	ND	2.00	µg/L		3/3/2017	3/15/2017
1703302-052A	5242-21.3	ND	2.00	µg/L		3/3/2017	3/15/2017
1703302-053A	5242-22.1	ND	2.00	µg/L		3/3/2017	3/15/2017
1703302-054A	5242-22.2	ND	2.00	µg/L		3/3/2017	3/15/2017
1703302-055A	5242-23.1	ND	2.00	µg/L		3/3/2017	3/15/2017
1703302-056A	5242-23.2	ND	2.00	µg/L		3/3/2017	3/15/2017
1703302-057A	5242-24.1	ND	2.00	µg/L		3/3/2017	3/15/2017
1703302-058A	5242-24.2	ND	2.00	µg/L		3/3/2017	3/15/2017
1703302-059A	5242-25.1	ND	2.00	µg/L		3/3/2017	3/15/2017
1703302-060A	5242-25.2	ND	2.00	µg/L		3/3/2017	3/15/2017
1703302-061A	5242-25.3	ND	2.00	µg/L		3/3/2017	3/15/2017

ND - Not Detected Down to the Laboratory Minimum Reporting Limit (MRL)

CHAIN OF CUSTODY

www.Eslichicago.com

708.354.7121

Suite 201 1415 West 55th Street, Countryside, IL 60525-6543

Laboratory Contacts: Karan Payne

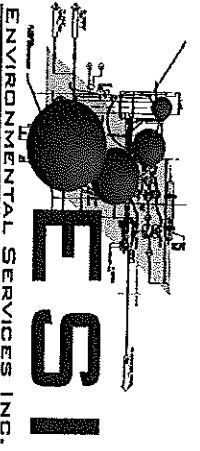

CONTACT INFORMATION

Company: Environmental Services, Inc.

Address: P. O. Box 688 LaGrange, IL 60525-0688

Contact: Nick Malone

Email: NMalone@Eslichicago.com

Phone: 708 354 7121

Fax: 708 354 7142

PROJECT INFORMATION

Project 5242 G67

Sampled By: ESL Sampling Date: 03 Mar 2017

PO Number:

Send Invoice to: N Malone

TURN AROUND TIME CODES - (TAT)

STD - Standard (DEFAULT 24-48 Hour)

ND - 24 Hour (call to schedule)

SD - Same Business Day Rush (call)

WH-Weekend/Holiday (call to schedule)

Please call us one to two days in advance of rush or weekend analysis needs to get your samples on the laboratory schedule.

SAMPLE ID	DESCRIPTION	Sample Type (Below)	TAT (Above)	Total Volume/Area (as applicable)	NOTES (Time of day, Flow Rate, Temp)
5242-1.1	Hynes 1st Draw Sink CW Rm 7	W	STD	250 mL	07:30 Friday
5242-1.2	Hynes 2nd Draw Sink CW Rm 7	W	STD	250 mL	All bottles plastic w/ HNC3
5242-1.3	Hynes 1st Draw Sink HW Rm 7	W	STD	250 mL	
5242-2.1	Hynes 1st Draw Sink CW Rm 5	W	STD	250 mL	
5242-2.2	Hynes 2nd Draw Sink CW Rm 5	W	STD	250 mL	
5242-2.3	Hynes 1st Draw Sink HW Rm 5	W	STD	250 mL	
5242-3.1	Hynes 1st Draw Sink CW Rm 3	W	STD	250 mL	
5242-3.2	Hynes 2nd Draw Sink CW Rm 3	W	STD	250 mL	
5242-3.3	Hynes 1st Draw Sink HW Rm 3	W	STD	250 mL	
5242-4.1	Hynes 1st Draw Sink CW Rm 1 East	W	STD	250 mL	
5242-4.2	Hynes 2nd Draw Sink CW Rm 1 East	W	STD	250 mL	
5242-4.3	Hynes 1st Draw Sink HW Rm 1 East	W	STD	250 mL	

SAMPLE TYPE CODES

B - Bulk Asbestos	WW - Wastewater	D - Dust
AA - Air Sample Asbestos	MIP - Manufactured Product	W - Water
MV - Microvac Asbestos	AS - Air sample	SO - Soil
FA - Food Asbestos	O -	SL - Sludge

RELINQUISHED BY

N Malone

Karan Payne

DATE & TIME

6-Mar-17

11:15

RECEIVED BY

Karan Payne

DATE & TIME

3-6-17

11:15

REQUESTED ANALYSES

Wastewater	Soil	Other Analyses
Standard	Other	Standard
Other	Standard	Other
Other	Other	Other

RD-920 BOD5	
RD-920 TSS	
Drinking Water Lead	X
Drinking Water Copper	
Drinking Water Iron	
Drinking Water Zinc	
pH	
RD-115 FOG	
RD-115 Total Metals	
RD-115 Total Cyanide	
RD-115 T Cr	

1703302

(16)

1703302

CHAIN OF CUSTODY

www.ESIchicago.com

708.354.7121
Suite 201 1415 West 55th Street, Countryside, IL 60525-6543

Laboratory Contacts: Karan Payne

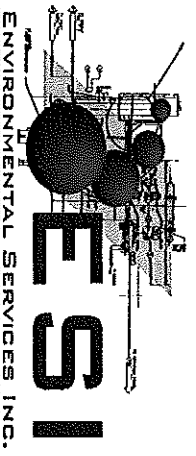

CONTACT INFORMATION

Company: Environmental Services, Inc. Address: P. O. Box 688 LaGrange, IL 60525-0688
 Contact: Nick Malone Email: NMalone@ESIchicago.com
 Phone: 708 354 7121 Fax: 708 354 7142

TURN AROUND TIME CODES - (TAT)

Project 5242 G67 Sampling Date: 03 Mar 2017
 By: ESI
 PO Number:
 Send Invoice to: N Malone

STD - Standard (DEFAULT 24-48 Hour)
 ND - 24 Hour (call to schedule)
 SD - Same Business Day Rush (call)
 W/H-Weekend/Holiday (call to schedule)

Please call us one to two days in advance of rush or weekend analysis needs to get your samples on the laboratory schedule.

SAMPLE ID	DESCRIPTION	Sample Type (Below)	TAT (Above)	Total Volume/Area (as applicable)	NOTES (Time of day, Flow Rate, Temp)
5242-9.1	Hynes 1st Draw Sink CW Rm 2 West	W	STD	250 mL	07:30 Friday
5242-9.2	Hynes 2nd Draw Sink CW Rm 2 West	W	STD	250 mL	All bottles plastic w/ HNO3
5242-9.3	Hynes 1st Draw Sink HW Rm 2 West	W	STD	250 mL	
5242-10.1	Hynes 1st Draw Bubbler Rm 2	W	STD	250 mL	
5242-10.2	Hynes 2nd Draw Bubbler Rm 2	W	STD	250 mL	
5242-11.1	Hynes 1st Draw TR Sink Combo Rm 2	W	STD	250 mL	
5242-11.2	Hynes 2nd Draw TR Sink Combo Rm 2	W	STD	250 mL	
5242-12.1	Hynes 1st Draw DF near Boiler Rm North	W	STD	250 mL	
5242-12.2	Hynes 2nd Draw DF near Boiler Rm North	W	STD	250 mL	
5242-13.1	Hynes 1st Draw DF near Boiler Rm South	W	STD	250 mL	
5242-13.2	Hynes 2nd Draw DF near Boiler Rm South	W	STD	250 mL	

SAMPLE TYPE CODES	RELINQUISHED BY	DATE & TIME	RECEIVED BY	DATE & TIME
B - Bulk Asbestos	N Malone	6-Mar-17	B. Bluman	3-6-17
AA - Air Sample Asbestos				
MV - Microvac Asbestos				
FA - Food Asbestos				

REQUESTED ANALYSES

Standard	Wastewater		Soil		Other Analyses
	Other	Standard	Other	Standard	
					RD-920 BOD5
					RD-920 TSS
	X				Drinking Water Lead
					Drinking Water Copper
					Drinking Water Iron
					Drinking Water Zinc
					pH
					RD-115 FOG
					RD-115 Total Metals
					RD-115 Total Cyanide
					RD-115 T Cr

CHAIN OF CUSTODY

www.ESIchicago.com

708.354.7121

Suite 201 1415 West 55th Street, Countryside, IL 60525-6543

Laboratory Contacts: Karan Payne

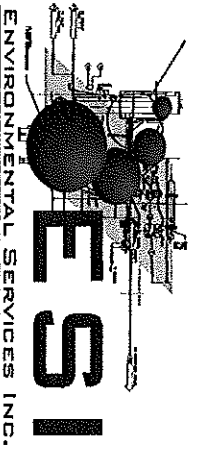

CONTACT INFORMATION

Company: Environmental Services, Inc.

Address: P. O. Box 688 LaGrange, IL 60525-0688

Contact: Nick Malone

Email: NMalone@ESIchicago.com

Phone: 708 354 7121

Fax: 708 354 7142

PROJECT INFORMATION

Project: 5242 G67

Sampled By: ESI
Sampling Date: 03 Mar 2017

PO Number:

Send Invoice to: N Malone

TURN AROUND TIME CODES - (TAT)

STD - Standard (DEFAULT 24-48 Hour)

ND - 24 Hour (call to schedule)

SD - Same Business Day Rush (call)

WH-Weekend/Holiday (call to schedule)

Please call us one to two days in advance of rush or weekend analysis needs to get your samples on the laboratory schedule.

SAMPLE ID	DESCRIPTION	Sample Type (Below)	TAT (Above)	Total Volume/Area (as applicable)	NOTES (Time of day, Flow Rate, Temp)
5242-14.1	Hynes 1st Draw Sink Combo Nurse	W	STD	250 mL	07:30 Friday
5242-14.2	Hynes 2nd Draw Sink Combo Nurse	W	STD	250 mL	All bottles plastic w/ HNC3
5242-15.1	Hynes 1st Draw Pot Sink Kitchen	W	STD	250 mL	
5242-15.2	Hynes 2nd Draw Pot Sink Kitchen	W	STD	250 mL	
5242-16.1	Hynes 1st Draw Sink Faucet CW Kitchen	W	STD	250 mL	
5242-16.2	Hynes 2nd Draw Sink Faucet CW Kitchen	W	STD	250 mL	
5242-16.3	Hynes 1st Draw Sink Faucet HW Kitchen	W	STD	250 mL	
5242-17.1	Hynes 1st Draw DF near Principal East	W	STD	250 mL	
5242-17.2	Hynes 2nd Draw DF near Principal East	W	STD	250 mL	
5242-18.1	Hynes 1st Draw DF near Principal West	W	STD	250 mL	
5242-18.2	Hynes 2nd Draw DF near Principal West	W	STD	250 mL	

SAMPLE TYPE CODES		RELINQUISHED BY		DATE & TIME	
B - Bulk Asbestos	WW - Wastewater	D - Dust	N Malone	6-Mar-17	
AA - Air Sample Asbestos	MP - Manufactured Product	W - Water	<i>Karan Payne</i>	11:15	
MV - Microvac Asbestos	AS - Air sample	SO - Soil			
FA - Food Asbestos	O -	SL - Sludge			

REQUESTED ANALYSES

Standard	Wastewater		Soil		Other Analyses
	Standard	Other	Standard	Other	
RD-920 BOD5					
RD-920 TSS					
Drinking Water Lead	X				
Drinking Water Copper					
Drinking Water Iron					
Drinking Water Zinc					
pH					
RD-115 FOG					
RD-115 Total Metals					
RD-115 Total Cyanide					
RD-115 T Cr					

RECEIVED BY

B. Malone 3-16-17 11:15

1703302

CHAIN OF CUSTODY

www.ESIchicago.com

708.354.7121
Suite 201 1415 West 55th Street, Countryside, IL 60525-6543

Laboratory Contacts: Karan Payne

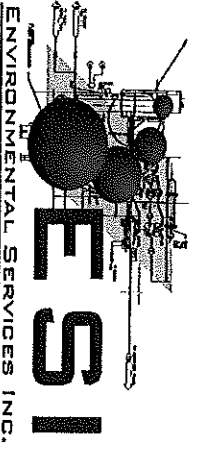

1703302

CONTACT INFORMATION

Company: Environmental Services, Inc. Address: P. O. Box 688 LaGrange, IL 60525-0688
 Contact: Nick Malone Email: NMalone@ESIchicago.com
 Phone: 708 354 7121 Fax: 708 354 7142

PROJECT INFORMATION

Project 5242 G67
 Sampled By: ESI 03 Mar 2017
 PO Number:
 Send Invoice to: N Malone

TURN AROUND TIME CODES - (TAT)

STD - Standard (DEFAULT 24-48 Hour)
 NID - 24 Hour (call to schedule)
 SD - Same Business Day Rush (call)
 WH-Weekend/Holiday (call to schedule)

Please call us one to two days in advance of rush or weekend analysis needs to get your samples on the laboratory schedule.

SAMPLE ID	DESCRIPTION	Sample Type (Below)	TAT (Above)	Total Volume/Area (as applicable)	NOTES (Time of day, Flow Rate, Temp)
5242-19.1	Hynes 1st Draw BF/DF MPR	W	STD	250 mL	07:30 Friday
5242-19.2	Hynes 2nd Draw BF/DF MPR	W	STD	250 mL	All bottles plastic w/ HNO3
5242-19.3	Hynes 1st Draw BF/DF MPR	W	STD	250 mL	
5242-20.1	Hynes 1st Draw DF MPR	W	STD	250 mL	
5242-20.2	Hynes 2nd Draw DF MPR	W	STD	250 mL	
5242-21.1	Hynes 1st Draw BF/DF near Gym	W	STD	250 mL	
5242-21.2	Hynes 2nd Draw BF/DF near Gym	W	STD	250 mL	
5242-21.3	Hynes 1st Draw BF/DF near Gym	W	STD	250 mL	
5242-22.1	Hynes 1st Draw DF near Gym	W	STD	250 mL	
5242-22.2	Hynes 2nd Draw DF near Gym	W	STD	250 mL	
5242-23.1	Hynes 2nd Draw DF near Rm 14 East	W	STD	250 mL	
5242-23.1	Hynes 2nd Draw DF near Rm 14 East	W	STD	250 mL	

SAMPLE TYPE CODES

B - Bulk Asbestos	WW - Wastewater	D - Dust
AA - Air Sample Asbestos	MP - Manufactured Product	W - Water
MV - Microvac Asbestos	AS - Air sample	SO - Soil
FA - Food Asbestos	O -	SL - Sludge

RELINQUISHED BY

N Malone
 6-Mar-17
 11:15

RECEIVED BY

B. D. Payne
 3-6-17 11:15

REQUESTED ANALYSES

Standard	Wastewater		Soil		Other Analyses
	Other	Standard	Other	Standard	
RD-920 BOD5					
RD-920 TSS					
Drinking Water Lead	X				
Drinking Water Copper					
Drinking Water Iron					
Drinking Water Zinc					
pH					
RD-115 FOG					
RD-115 Total Metals					
RD-115 Total Cyanide					
RD-115 T Cr					

CHAIN OF CUSTODY

www.ESIchicago.com

708.354.7121

Suite 201 1415 West 55th Street, Countryside, IL 60525-6543

Laboratory Contacts: Karan Payne

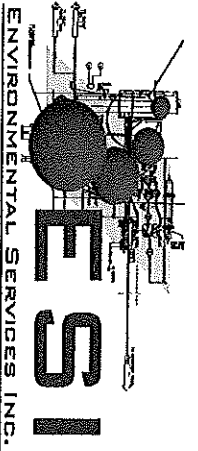

CONTACT INFORMATION

Company: Environmental Services, Inc.

Address: P. O. Box 688 LaGrange, IL 60525-0688

Contact: Nick Malone

Email: NMalone@ESIchicago.com

Phone: 708 354 7121

Fax: 708 354 7142

PROJECT INFORMATION

Project 5242 G67

STD - Standard (DEFAULT 24-48 Hour)

Sampled By: ESI

Sampling Date: 03 Mar 2017

ND - 24 Hour (call to schedule)

PO Number:

SD - Same Business Day Rush (call)

Send Invoice to: N Malone

WH-Weekend/Holiday (call to schedule)

Please call us one to two days in advance of rush or weekend analysis needs to get your samples on the laboratory schedule.

TURN AROUND TIME CODES - (TAT)

SAMPLE ID	DESCRIPTION	Sample Type (Below)	TAT (Above)	Total Volume/Area (as applicable)	NOTES (Time of day, Flow Rate, Temp)
5242-24.1	Hynes 2nd Draw DF near Rm 14 West	W	STD	250 mL	07:30 Friday
5242-24.2	Hynes 2nd Draw DF near Rm 14 West	W	STD	250 mL	All bottles plastic w/ HNO3
5242-25.1	Hynes 1st Draw Sink Faucet CW Rm 13	W	STD	250 mL	
5242-25.2	Hynes 2nd Draw Sink Faucet CW Rm 13	W	STD	250 mL	
5242-25.3	Hynes 1st Draw Sink Faucet HW Rm 13	W	STD	250 mL	

SAMPLE TYPE CODES

B - Bulk Asbestos	WW - Wastewater	D - Dust
AA - Air Sample Asbestos	MP - Manufactured Product	W - Water
MV - Microvac Asbestos	AS - Air sample	SO - Soil
FA - Food Asbestos	O -	SL - Sludge

RELINQUISHED BY

N Malone

Karan Payne

DATE & TIME

6-Mar-17

11:15

REQUESTED ANALYSES

Standard	Wastewater		Soil		Other Analyses
	Standard	Other	Standard	Other	
RD-920 BOD5					
RD-920 TSS					
Drinking Water Lead		X			
Drinking Water Copper		X			
Drinking Water Iron		X			
Drinking Water Zinc		X			
pH					
RD-115 FOG					
RD-115 Total Metals					
RD-115 Total Cyanide					
RD-115 T Cr					

RECEIVED BY

B. Johnson

DATE & TIME

3-6-17 11:55

1703302